

Double acting cylinders

STC Pivot Type	
STC..B Pivot Type (with Cushion)	
STA Front Nose Mounting Type	
STA..B Front Nose Mounting Type (with Cushion)	
STD Double End Rod Type	
STD..B Double End Rod Type (with Cushion)	
STN..N..A, STN..N..B Adjustable Forward Stroke Type	A:25mm B:50mm
STN..B..A, STN..B..B Adjustable Forward Stroke Type (with Cushion)	A:25mm B:50mm



- ST series cylinders according to ISO 6432 (Bore sizes φ 20~ φ 25.)
- The series cylinders use for long stroke and high speed.

Specification

Bore sizes of cylinder (mm)	φ 20	φ 25	φ 32	φ 40
Standard stroke (mm)	25,50,75,100,125,150,175,200,250,300			
The range of stroke (mm)	Max. 800			
Power fluid	Filtered air or hydraulic oil			
Material of cylinder barrel	Stainless steel			
The range of pressure (MPa)	0.1~1.03			
The range of temperature (°C)	-10~+60			

How to order

STN	25	B	100	B	LB - Y - LN01B	×	2
Type	Bore	Cushion	Stroke	Adjustable stroke	Accessory	Sensor switch	Quantity
 STC	20—φ 20mm 25—φ 25mm 32—φ 32mm 40—φ 40mm	B: Both end with cushion N: No cushion	25—25mm 50—50mm 75—75mm 100—100mm 125—125mm 150—150mm 175—175mm 200—200mm 250—250mm 300—300mm	None: standard A: Adjustable 25mm B: Adjustable 50mm Note: this number can only be used for the adjustable type.	 FA FB LB CU Y I G K	 LN01B LN48R	1: 1pc 2: 2pcs
 STA							
 STD							
 STN							

Note:
1.Can choose NPN or PNP type (3-Wire type, 24VDC).
2.Can choose plug-in cable.
3.For details see page 4-1.2 or 4-1.7.

Dimensional features

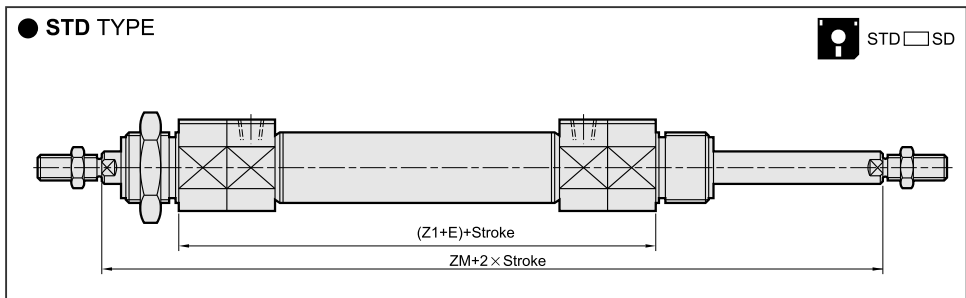
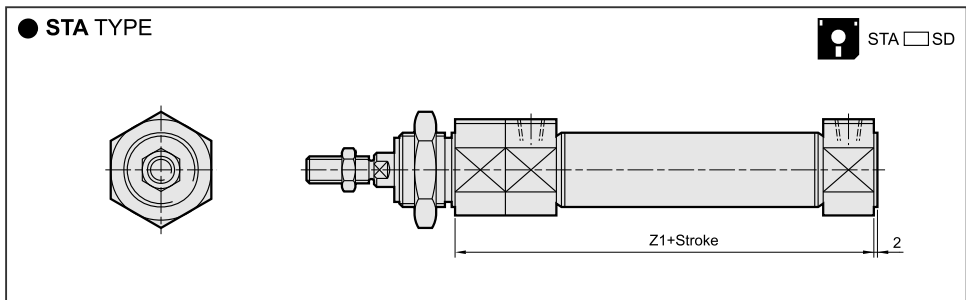
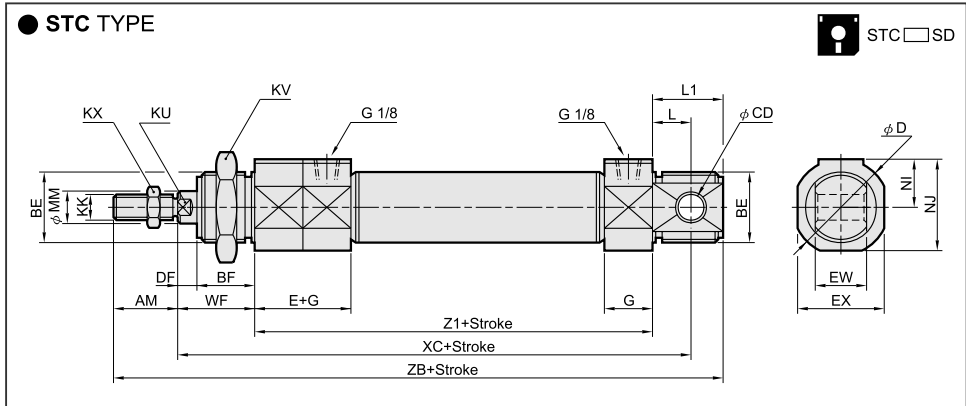

- DA
- DP
- DS
- DQ
- DB
- DN
- BN
- ST
- NT
- DU
- DJ
- TA
- GP
- GS
- GM
- GT
- RT
- CT
- CH

Dimensional Table

Bore	AM	BE	BF	CD	D	DF	E	EX	EW	G	KK	KU	KV	KX	L	L1	MM	NI	NJ	WF	XC	Z1	ZB	ZM
φ 20	20	M22×1.5	18	8	30	6	25	27	16	15	M8×1.25	7	32	14	12	22	8	15	28.5	24	120	84	150	157
φ 25	22	M22×1.5	20	8	30	8	25	27	16	16	M10×1.25	9	32	17	12	22	10	15	28.5	28	129	89	161	170
φ 32	23	M27×2.0	20	10	38	8	25	35	20	16	M10×1.25	10	35	17	15	27	12	19	36.5	28	140	97	175	178
φ 40	23	M33×2.0	20	10	45	8	25	42	20	16	M14×1.5	14	41	22	15	27	16	22.5	43.5	28	140	97	175	178

Dimensional features

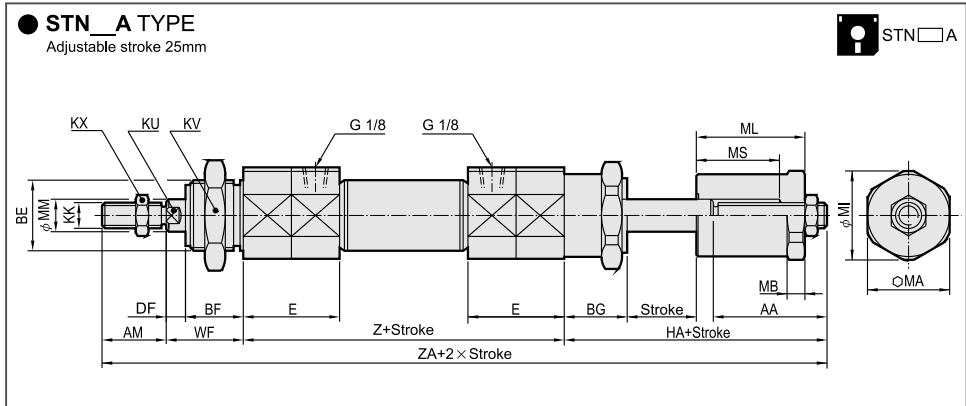

Dimensional Table

Bore	AA	AM	BE	BF	DF	BG	E	KK	KU	KV	KX	HA	MA	MB	MI	ML	MM	MS	WF	Z	ZA
φ 20	45	20	M22×1.5	18	6	25	40	M8×1.25	7	27	14	78	22	8	24	43	8	33	24	109	231
φ 25	46	22	M22×1.5	20	8	25	41	M10×1.25	9	27	17	79	22	8	24	45	10	35	28	114	243
φ 32	46	23	M27×2.0	20	8	25	41	M10×1.25	10	35	17	79	27	10	29	45	12	35	28	122	252
φ 40	50	23	M33×2.0	20	8	25	41	M14×1.5	14	41	22	83	32	10	35	47	16	35	28	122	256

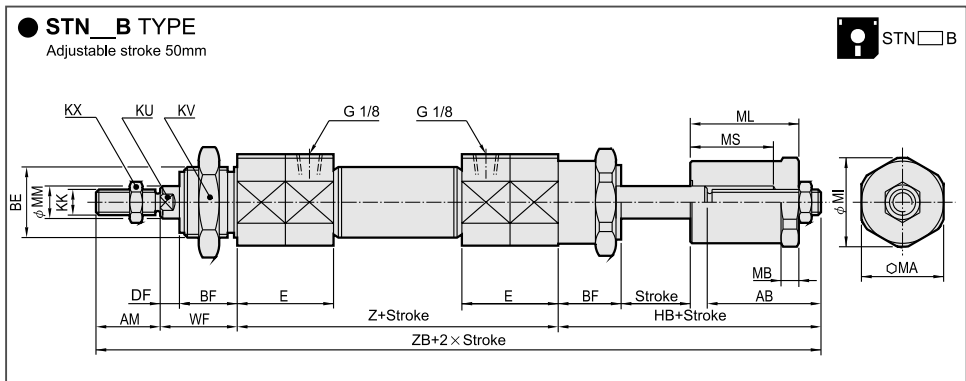

Dimensional Table

Bore	AB	AM	BE	BF	BG	DF	E	KK	KU	KV	KX	HB	MA	MB	MI	ML	MM	MS	WF	Z	ZB
φ 20	70	20	M22×1.5	18	6	25	40	M8×1.25	7	27	14	103	22	8	24	68	8	58	24	109	256
φ 25	71	22	M22×1.5	20	8	25	41	M10×1.25	9	27	17	104	22	8	24	70	10	60	28	114	268
φ 32	71	23	M27×2.0	20	8	25	41	M10×1.25	10	35	17	104	27	10	29	70	12	60	28	122	277
φ 40	75	23	M33×2.0	20	8	25	41	M14×1.5	14	41	22	108	32	10	35	72	16	60	28	122	281

Mounting Dimension of Double Acting Cylinders

● FA(FB) TYPE Bore φ 20, φ 25

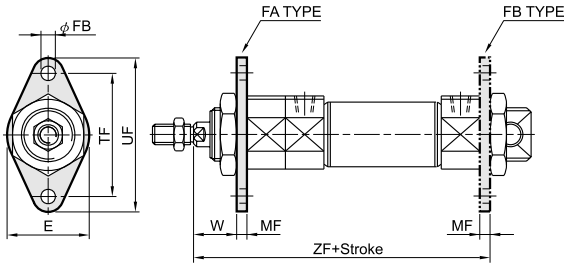

Bore φ 32, φ 40

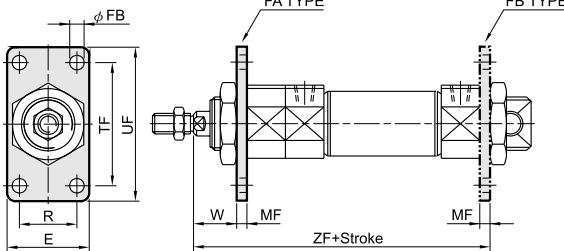

● LB TYPE

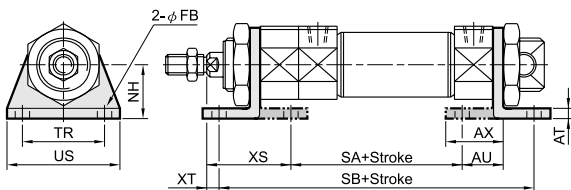

● CU TYPE

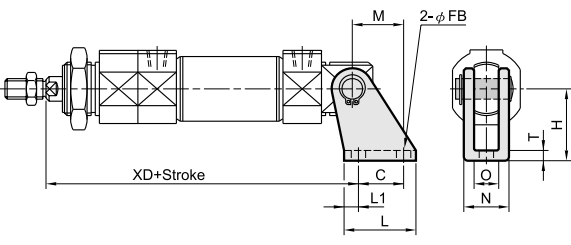

Dimensional Table

Type	Bore	E	FB	MF	R	TF	UF
FA-20	φ 20	40	7	5	-	50	66
FA-25	φ 25	40	7	5	-	50	66
FA-32	φ 32	45	7	5	20	60	80
FA-40	φ 40	50	9	5	30	80	100
Type	Bore	W	ZF				
FA-20	φ 20	19	113				
FA-25	φ 25	23	124				
FA-32	φ 32	23.5	131.5				
FA-40	φ 40	23.5	131.5				



Dimensional Table

Type	Bore	AT	AU	AX	FB	NH	SA
LB-20	φ 20	5	17	25	7	25	60
LB-25	φ 25	5	17	25	7	25	67
LB-32	φ 32	5	20	30	7	35	68
LB-40	φ 40	5	20	30	9	40	68
Type	Bore	SB	TR	US	XT	XS	
LB-20	φ 20	118	40	54	7	36	
LB-25	φ 25	125	40	54	11	40	
LB-32	φ 32	139	40	55	8	43.5	
LB-40	φ 40	139	50	75	8	43.5	



Dimensional Table

Type	Bore	C	FB	H	L	L1	M
CU-20	φ 20	20	7	30	32	6	16
CU-25	φ 25	20	7	30	32	6	16
CU-32	φ 32	25	7	40	40	7.5	20
CU-40	φ 40	25	9	40	40	7.5	20
Type	Bore	N	O	T	XD		
CU-20	φ 20	24	16	4	116		
CU-25	φ 25	24	16	4	127		
CU-32	φ 32	28	20	4	137		
CU-40	φ 40	28	20	4	137		

DA

DP

DS

DQ

DB

DN

BN

ST

NT

DU

DJ

TA

GP

GS

GM

GT

RT

CT

CH

Mounting Dimension of Double Acting Cylinders

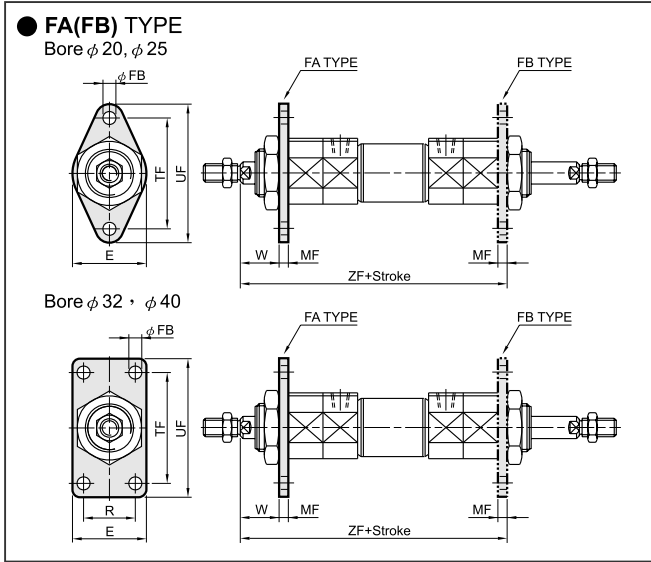

Dimensional Table

Type	Bore	E	FB	MF	R
FA-20	φ 20	40	7	5	-
FA-25	φ 25	40	7	5	-
FA-32	φ 32	45	7	5	20
FA-40	φ 40	50	9	5	30

Type	Bore	TF	UF	W	ZF
FA-20	φ 20	50	66	19	138
FA-25	φ 25	50	66	23	151
FA-32	φ 32	60	80	23.5	158.5
FA-40	φ 40	80	100	23.5	158.5



Dimensional Table

Type	Bore	AT	AU	AX	FB	NH	SA
LB-20	φ 20	5	17	25	7	25	85
LB-25	φ 25	5	17	25	7	25	94
LB-32	φ 32	5	20	30	7	35	95
LB-40	φ 40	5	20	30	9	40	95

Type	Bore	SB	TR	US	XT	XS
LB-20	φ 20	143	40	54	7	36
LB-25	φ 25	152	40	54	11	40
LB-32	φ 32	166	40	55	8	43.5
LB-40	φ 40	166	50	75	8	43.5

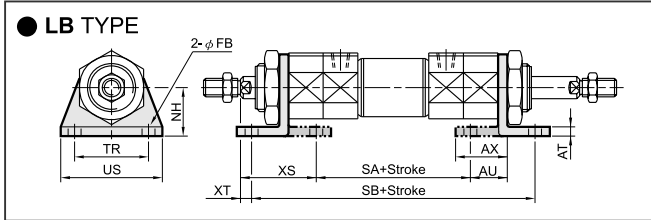

Installation of sensor switches

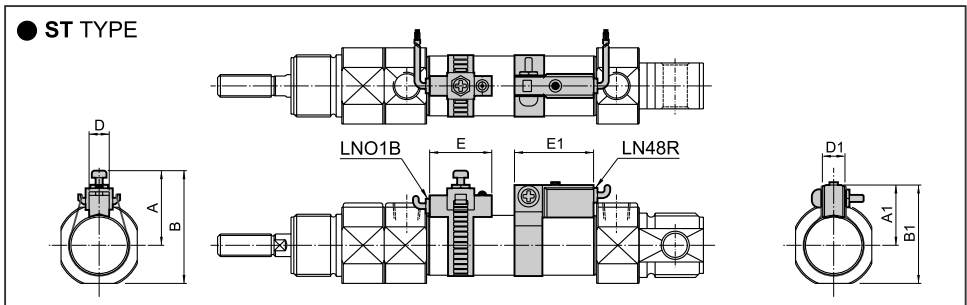

Dimensional Table

Bore	Sensor switch	A	B	D	E
φ 20	LN01B	25.5	39	7	22
φ 25	LN01B	28.4	41.9	7	22
φ 32	LN01B	32	49.5	7	22
φ 40	LN01B	36.3	57.3	7	22

Bore	Sensor switch	Clamp NO.	A1	B1	D1	E1
φ 20	LN48R	BS-S20	22	36	8	28
φ 25	LN48R	BS-S25	24	38	8	28
φ 32	LN48R	BS-S32	28	46	8	28
φ 40	LN48R	BS-S40	32	53	8	28

Accessories

● Y Rod Clevis (With Pin)

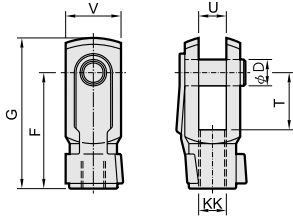

Dimensional Table

Type	Bore	D	F	G	KK	T	U	V
Y-M8 × 1.25	φ 20	8	32	42	M8 × 1.25	16	8	16
Y-M10 × 1.25	φ 25, φ 32	10	40	52	M10 × 1.25	20	10	20
Y-M14 × 1.5	φ 40	10	45	58	M14 × 1.5	20	14	25



Type	Filename
Y-M8 × 1.25	YM08125
Y-M10 × 1.25	YM10125
Y-M14 × 1.5	YM14150

● I Rod End Mounting

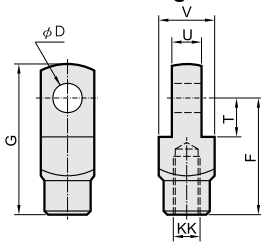

Dimensional Table

Type	Bore	D	F	G	KK	T	U	V
I-M8 × 1.25	φ 20	8	32	42	M8 × 1.25	11	8	16
I-M10 × 1.25	φ 25, φ 32	10	40	52	M10 × 1.25	13	10	19
I-M14 × 1.5	φ 40	10	45	57	M14 × 1.5	13	14	25.4



Type	Filename
I-M8 × 1.25	IM08125
I-M10 × 1.25	IM10125
I-M14 × 1.5	IM14150

● Oscillating Eye

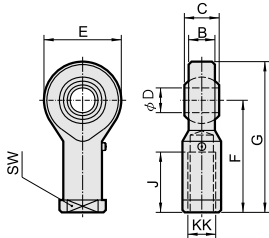

Dimensional Table

Type	Bore	B	C	D	E	F	G	J	KK	SW
G-M8 × 1.25	φ 20	9	12	8	22	36	47	17	M8 × 1.25	14
G-M10 × 1.25	φ 25, φ 32	10.5	14	10	26	43	56	21	M10 × 1.25	17
G-M14 × 1.5	φ 40	13.5	19	14	34	57	74	27	M14 × 1.5	22



Type	Filename
G-M8 × 1.25	GM08125
G-M10 × 1.25	GM10125
G-M14 × 1.5	GM14150

● Compensating Joint

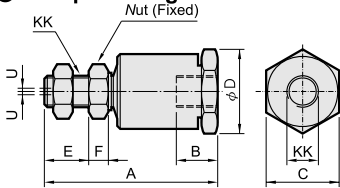

Dimensional Table

Type	Bore	A	B	C	D	E	F	KK	U
K-M8 × 1.25	φ 20	47	11	19	20	14.5	5	M8 × 1.25	0.75
K-M10 × 1.25	φ 25, φ 32	54	13	24	25.5	14.5	6	M10 × 1.25	1
K-M14 × 1.5	φ 40	70	17	29	31	19	8	M14 × 1.5	1.15



Type	Filename
K-M8 × 1.25	KM08125
K-M10 × 1.25	KM10125
K-M14 × 1.5	KM14150

● Mounting Nut

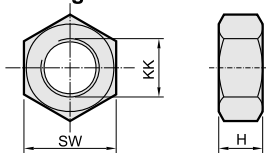

Dimensional Table

Type	Bore	H	KK	SW	Type	Filename
N-M8 × 1.25	φ 20	5	M8 × 1.25	14	N-M8 × 1.25	NM08125
N-M10 × 1.25	φ 25, φ 32	6	M10 × 1.25	17	N-M10 × 1.25	NM10125
N-M14 × 1.5	φ 40	7	M14 × 1.5	22	N-M14 × 1.5	NM14150
N-M22 × 1.5	φ 20, φ 25	6	M22 × 1.5	27	N-M22 × 1.5	NM22150
N-M27 × 2.0	φ 32	8	M27 × 2.0	35	N-M27 × 2.0	NM27200
N-M33 × 2.0	φ 40	8	M33 × 2.0	41	N-M33 × 2.0	NM33200



DA

DP

DS

DQ

DB

DN

BN

ST

NT

DU

DJ

TA

GP

GS

GM

GT

RT

CT

CH

Double acting cylinders

NTB Double Acting - Single End Rod Type	
NTB..M Double Acting - Single End Rod Type (piston with magnet)	
NTD Double Acting - Double End Rod Type	
NTD..M Double Acting - Double End Rod Type (piston with magnet)	
NTN..N..A, NTN..N..B Adjustable Forward Stroke Cylinder	A:25mm B:50mm
NTN..M..A, NTN..M..B Adjustable Forward Stroke Cylinder (piston with magnet)	A:25mm B:50mm



- NT Series cylinders according to ISO 6431 (Bore sizes φ 32 ~ φ 100)
- The series cylinders use for long stroke and high speed.

Specification

Bore sizes of cylinder (mm)	φ 32	φ 40	φ 50	φ 63	φ 80	φ 100
Standard stroke (mm)	25,50,75,100,125,150,175,200,250,300,350,400,450,500					
The range of stroke (mm)	Stroke till 2500mm by request					
Power fluid	Filtered air with or without lubrication					
Material of cylinder barrel	Aluminium extrusion, Anodised 20 microns					
The range of pressure (MPa)	0.1~1.03					
The range of temperature (°C)	-10~+60					

How to order

NTN	50	N	125	B	FA - Y - LN01A	×	2
Type	Bore	Magnet	Stroke	Adjustable stroke	Accessory	Sensor switch	Quantity
 NTB	32—φ 32mm 40—φ 40mm 50—φ 50mm 63—φ 63mm 80—φ 80mm 100—φ 100mm	M: With magnet N: No magnet	25—25mm 50—50mm 75—75mm 100—100mm 125—125mm 150—150mm 175—175mm 200—200mm 250—250mm 300—300mm 350—350mm 400—400mm 450—450mm 500—500mm	None: standard A: Adjustable 25mm B: Adjustable 50mm Note: this number can only be used for the adjustable type.	 FA FB TC CA CB LB Y G K	 LN01A: Suited for φ 32, φ 40 LN02A: Suited for φ 50, φ 63 LN03A: Suited for φ 80, φ 100 Note: 1.Can choose NPN or PNP type (3-Wire type, 24VDC). 2.Can choose plug-in cable. 3.For details see page 4-1.1.	1: 1pc 2: 2pcs

Dimensional features

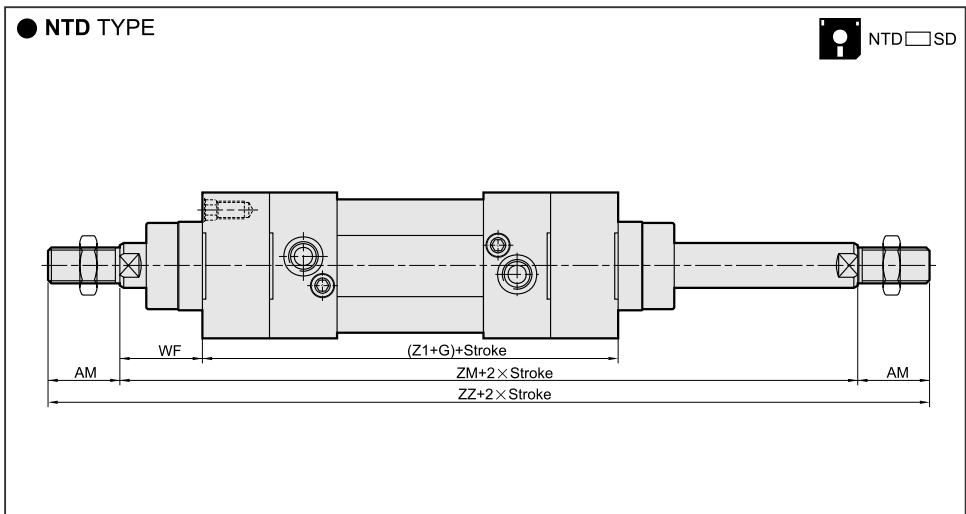
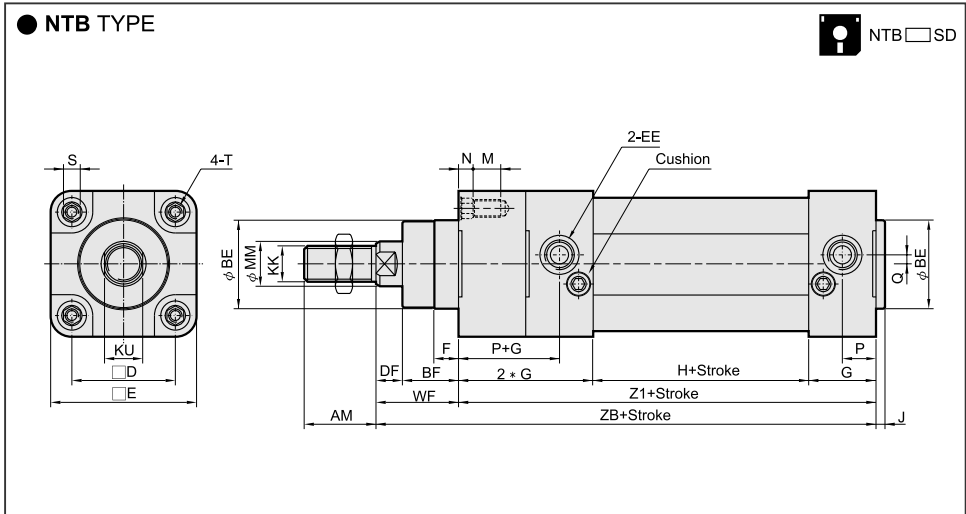

Dimensional Table

Bore	AM	BE	BF	D	DF	E	EE	F	G	H	J	KK	KU	M	MM	N	P	Q	S	T	WF	Z1	ZB	ZM	ZZ
φ 32	22	30	16	32.5	10	47	G 1/8	7	26	42	4	M10×1.25	10	9	12	6	13	4.5	6	M6	26	120	146	198	242
φ 40	24	35	20	38	10	53	G 1/4	9	30	45	5	M12×1.25	14	9	16	6	15	5	6	M6	30	135	165	225	273
φ 50	32	40	25	46.5	12	65	G 1/4	11	30	46	5	M16×1.5	17	12	20	6	15	6	8	M8	37	136	173	240	304
φ 63	32	45	25	56.5	12	75	G 3/8	4	32	57	5	M16×1.5	17	12	20	6	16	8	8	M8	37	153	190	259	323
φ 80	40	45	33	72	13	95	G 3/8	15	38	52	6	M20×1.5	22	16	25	6	19	9	10	M10	46	166	212	296	376
φ 100	40	55	35	89	16	115	G 1/2	15	40	58	6	M20×1.5	22	16	25	6	20	7	10	M10	51	178	229	320	400

DA

DP

DS

DQ

DB

DN

BN

ST

NT

DU

DJ

TA

GP

GS

GM

GT

RT

CT

CH

Accessories

● FA TYPE - Front Flange

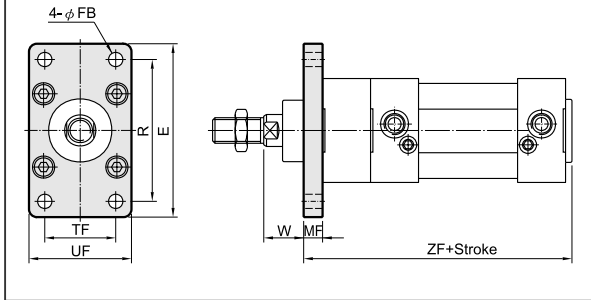

Dimensional Table

Bore	E	FB	MF	R	TF	UF	W	ZF
φ 32	79	7	10	64	32	50	16	134
φ 40	90	9	10	72	36	55	20	150
φ 50	110	9	12	90	45	65	25	153
φ 63	120	9	12	100	50	75	25	170
φ 80	153	12	16	126	63	95	30	188
φ 100	178	14	16	150	75	115	35	200

● FB TYPE - Rear Flange

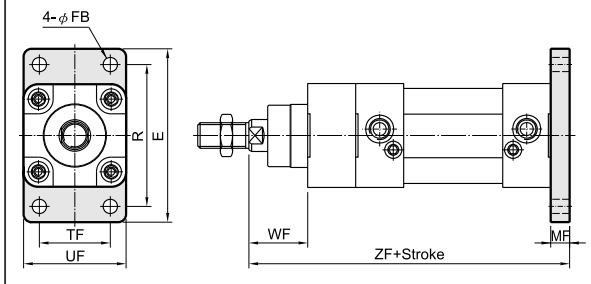

Dimensional Table

Bore	E	FB	MF	R	TF	UF	WF	ZF
φ 32	79	7	10	64	32	50	26	156
φ 40	90	9	10	72	36	55	30	175
φ 50	110	9	12	90	45	65	37	185
φ 63	120	9	12	100	50	75	37	202
φ 80	153	12	16	126	63	95	46	228
φ 100	178	14	16	150	75	115	51	245

● CA TYPE - Male Pivot

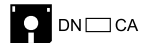
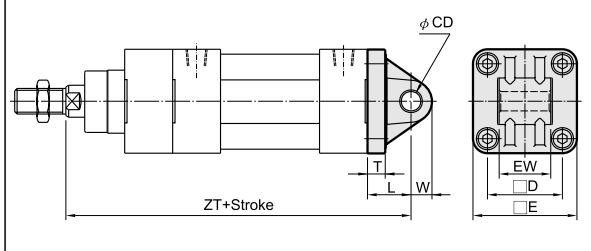

Dimensional Table

Bore	CD	D	E	EW	L	T	W	ZT
φ 32	10	32.5	47	26	22	10	10.5	168
φ 40	12	38	53	28	25	10	13	190
φ 50	12	46.5	65	32	27	11	13	200
φ 63	16	56.5	75	40	32	11	17	222
φ 80	16	72	95	50	36	15	17	248
φ 100	20	89	115	60	41	15	21	270

● CB TYPE - Female Pivot

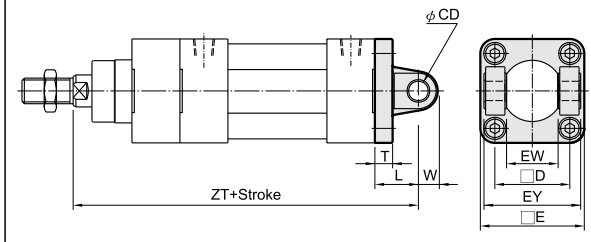

Dimensional Table

Bore	CD	D	E	EW	EY	L	T	W	ZT
φ 32	10	32.5	47	26	45	22	10	10.5	168
φ 40	12	38	53	28	52	25	10	13	190
φ 50	12	46.5	65	32	60	27	11	13	200
φ 63	16	56.5	75	40	70	32	11	17	222
φ 80	16	72	95	50	90	36	15	17	248
φ 100	20	89	115	60	110	41	15	21	270

Accessories

● TC TYPE - Intermediate Pivot

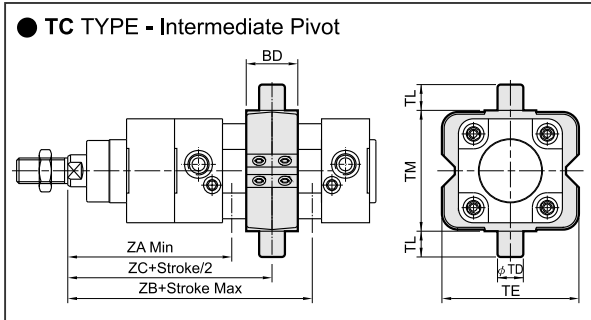

Dimensional Table

Bore	BD	TD	TE	TL	TM	ZA	ZB	ZC
φ 32	22	12	58	12	50	89	109	99
φ 40	28	16	70	16	63	104	121	112.5
φ 50	32	16	85	16	75	113	127	120
φ 63	35	20	100	20	90	118.5	140.5	129.5
φ 80	40	20	120	20	110	142	154	148
φ 100	45	25	145	25	132	153.5	166.5	160

DA

DP

DS

DQ

DB

DN

BN

ST

NT

DU

DJ

TA

GP

GS

GM

GT

RT

CT

CH

● LB TYPE - Foot Mounting

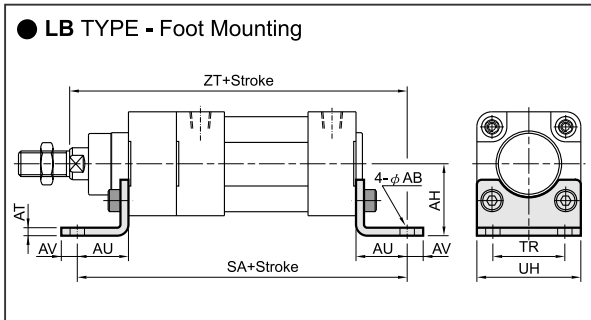

Dimensional Table

Bore	AB	AH	AT	AU	AV	SA	TR	UH	ZT
φ 32	7	32	5	24	8	168	32	47	170
φ 40	9	36	5	28	10	191	36	53	193
φ 50	9	45	5	32	10	200	45	65	205
φ 63	9	50	5	32	10	217	50	75	222
φ 80	12	63	6	41	13	248	63	95	253
φ 100	14	71	6	41	15	260	75	115	270

Installation of sensor switches

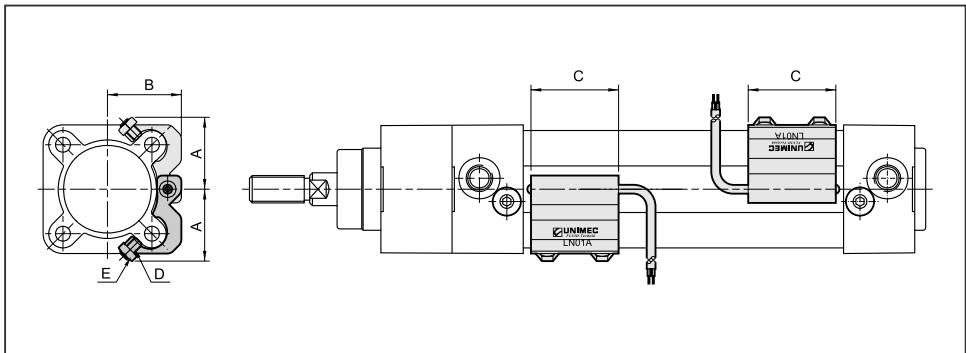

Dimensional Table

Bore	Sensor switch	A	B	C	D	E
φ 32	LN01A	26.3	27	32	M4 × 12L	M4
φ 40	LN01A	29	32	32	M4 × 12L	M4
φ 50	LN02A	35.5	36.5	32	M4 × 12L	M4
φ 63	LN02A	40	43	32	M4 × 12L	M4
φ 80	LN03A	49.5	52	32	M4 × 12L	M4
φ 100	LN03A	57.5	62	32	M4 × 12L	M4

Dimensional features

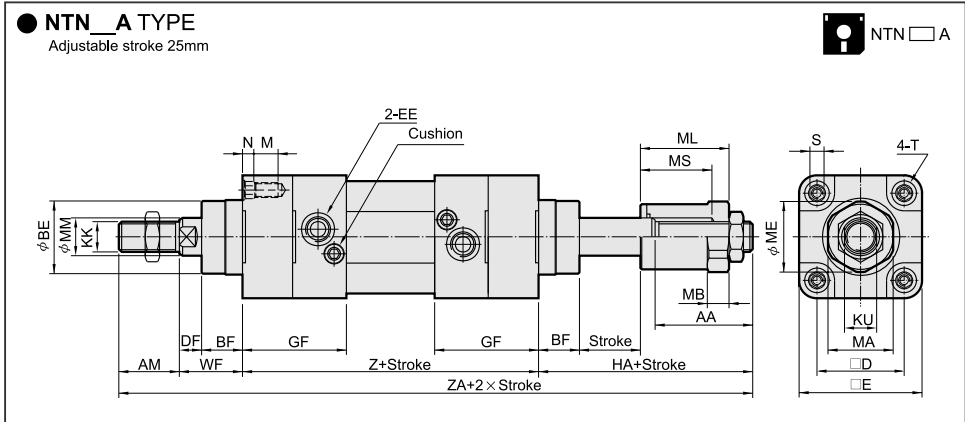

Dimensional Table

Bore	AA	AM	BE	BF	D	DF	E	EE	GF	HA	KK	KU	M	MA	MB	ME	ML	MM	MS	N	S	T	WF	Z	ZA
φ 32	47	22	30	16	32.5	10	47	G 1/8	52	73	M10×1.25	10	9	27	10	29	47	12	37	6	6	M6	26	146	267
φ 40	48	24	35	20	38	10	53	G 1/4	60	78	M12×1.25	14	9	32	10	35	47	16	37	6	6	M6	30	165	297
φ 50	52	32	40	25	46.5	12	65	G 1/4	60	92	M16×1.5	17	12	41	12	44	56	20	41	6	8	M8	37	166	327
φ 63	52	32	45	25	56.5	12	75	G 3/8	64	92	M16×1.5	17	12	41	12	44	56	20	41	6	8	M8	37	185	346
φ 80	58	40	45	33	72	13	95	G 3/8	76	107	M20×1.5	22	16	50.8	15	55	63	25	43	6	10	M10	46	204	397
φ 100	58	40	55	35	89	16	115	G 1/2	80	107	M20×1.5	22	16	50.8	15	55	63	25	43	6	10	M10	51	218	416

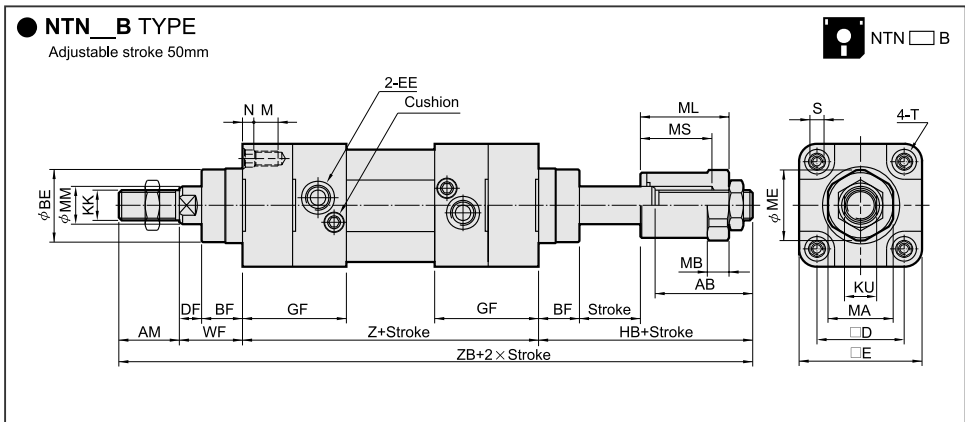

Dimensional Table

Bore	AB	AM	BE	BF	D	DF	E	EE	GF	HB	KK	KU	M	MA	MB	ME	ML	MM	MS	N	S	T	WF	Z	ZB
φ 32	72	22	30	16	32.5	10	47	G 1/8	52	98	M10×1.25	10	9	27	10	29	72	12	62	6	6	M6	26	146	292
φ 40	73	24	35	20	38	10	53	G 1/4	60	103	M12×1.25	14	9	32	10	35	72	16	62	6	6	M6	30	165	322
φ 50	77	32	40	25	46.5	12	65	G 1/4	60	117	M16×1.5	17	12	41	12	44	81	20	66	6	8	M8	37	166	352
φ 63	77	32	45	25	56.5	12	75	G 3/8	64	117	M16×1.5	17	12	41	12	44	81	20	66	6	8	M8	37	185	371
φ 80	83	40	45	33	72	13	95	G 3/8	76	132	M20×1.5	22	16	50.8	15	55	88	25	68	6	10	M10	46	204	422
φ 100	83	40	55	35	89	16	115	G 1/2	80	132	M20×1.5	22	16	50.8	15	55	88	25	68	6	10	M10	51	218	441

Accessories

● FA TYPE - Front Flange

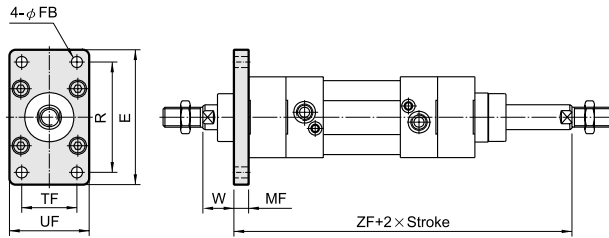

Dimensional Table

Bore	E	FB	MF	R	TF	UF	W	ZF
φ 32	79	7	10	64	32	50	16	182
φ 40	90	9	10	72	36	55	20	205
φ 50	110	9	12	90	45	65	25	215
φ 63	120	9	12	100	50	75	25	234
φ 80	153	12	16	126	63	95	30	266
φ 100	178	14	16	150	75	115	35	285

DA

DP

DS

DQ

DB

DN

BN

ST

NT

DU

DJ

TA

GP

GS

GM

GT

RT

CT

CH

● FB TYPE - Rear Flange

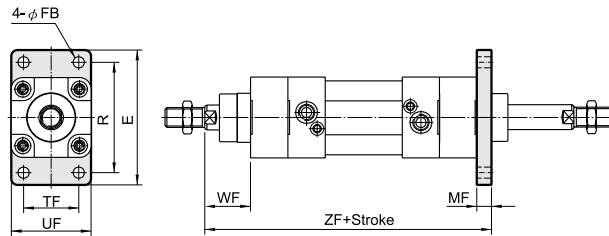

Dimensional Table

Bore	E	FB	MF	R	TF	UF	WF	ZF
φ 32	79	7	10	64	32	50	26	182
φ 40	90	9	10	72	36	55	30	205
φ 50	110	9	12	90	45	65	37	215
φ 63	120	9	12	100	50	75	37	234
φ 80	153	12	16	126	63	95	46	266
φ 100	178	14	16	150	75	115	51	285

● TC TYPE - Intermediate Pivot

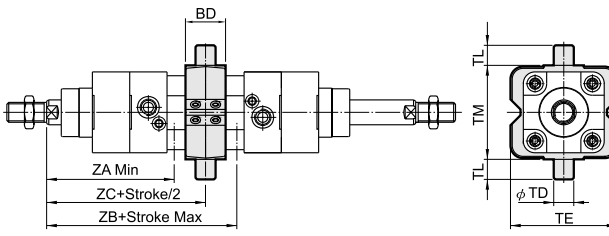

Dimensional Table

Bore	BD	TD	TE	TL	TM	ZA	ZB	ZC
φ 32	22	12	58	12	50	89	109	99
φ 40	28	16	70	16	63	104	121	112.5
φ 50	32	16	85	16	75	113	127	120
φ 63	35	20	100	20	90	118.5	140.5	129.5
φ 80	40	20	120	20	110	142	154	148
φ 100	45	25	145	25	132	153.5	166.5	160

● LB TYPE - Foot Mounting

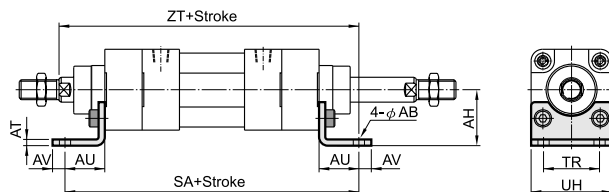

Dimensional Table

Bore	AB	AH	AT	AU	AV	SA	TR	UH	ZT
φ 32	7	32	5	24	8	194	32	47	196
φ 40	9	36	5	28	10	221	36	53	223
φ 50	9	45	5	32	10	230	45	65	235
φ 63	9	50	5	32	10	249	50	75	254
φ 80	12	63	6	41	13	286	63	95	291
φ 100	14	71	6	41	15	300	75	115	310

Accessories

● FA TYPE - Front Flange

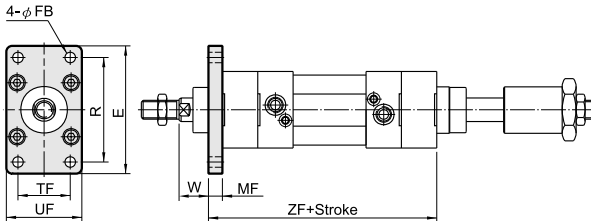

Dimensional Table

Bore	E	FB	MF	R	TF	UF	W	ZF
φ 32	79	7	10	64	32	50	16	156
φ 40	90	9	10	72	36	55	20	175
φ 50	110	9	12	90	45	65	25	178
φ 63	120	9	12	100	50	75	25	197
φ 80	153	12	16	126	63	95	30	220
φ 100	178	14	16	150	75	115	35	234

● FB TYPE - Rear Flange

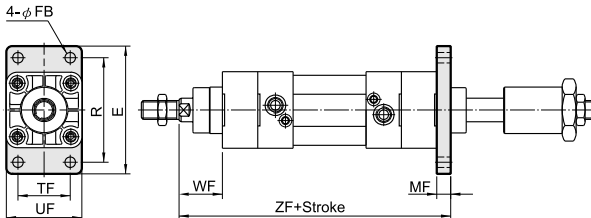

Dimensional Table

Bore	E	FB	MF	R	TF	UF	WF	ZF
φ 32	79	7	10	64	32	50	26	182
φ 40	90	9	10	72	36	55	30	205
φ 50	110	9	12	90	45	65	37	215
φ 63	120	9	12	100	50	75	37	234
φ 80	153	12	16	126	63	95	46	266
φ 100	178	14	16	150	75	115	51	285

● TC TYPE - Intermediate Pivot

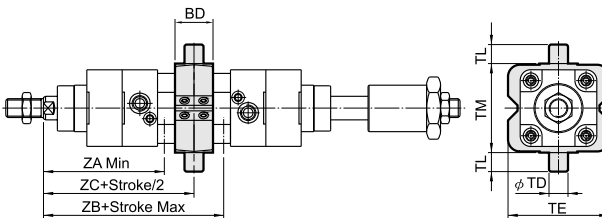

Dimensional Table

Bore	BD	TD	TE	TL	TM	ZA	ZB	ZC
φ 32	22	12	58	12	50	89	109	99
φ 40	28	16	70	16	63	104	121	112.5
φ 50	32	16	85	16	75	113	127	120
φ 63	35	20	100	20	90	118.5	140.5	129.5
φ 80	40	20	120	20	110	142	154	148
φ 100	45	25	145	25	132	153.5	166.5	160

● LB TYPE - Foot Mounting

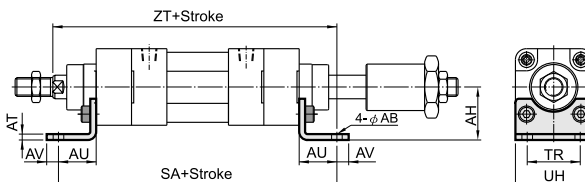

Dimensional Table

Bore	AB	AH	AT	AU	AV	SA	TR	UH	ZT
φ 32	7	32	5	24	8	194	32	47	196
φ 40	9	36	5	28	10	221	36	53	223
φ 50	9	45	5	32	10	230	45	65	235
φ 63	9	50	5	32	10	249	50	75	254
φ 80	12	63	6	41	13	286	63	95	291
φ 100	14	71	6	41	15	300	75	115	310

Accessories

● Y Rod Clevis (With Pin)

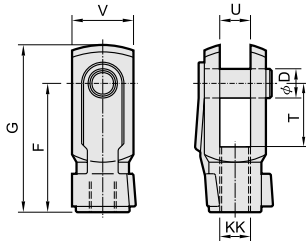

Dimensional Table

Type	Bore	D	F	G	KK	T	U	V
Y-M10 × 1.25	φ 32	10	40	52	M10 × 1.25	20	10	20
Y-M12 × 1.25	φ 40	12	48	62	M12 × 1.25	24	12	24
Y-M16 × 1.5	φ 50, φ 63	16	64	83	M16 × 1.5	32	16	32
Y-M20 × 1.5	φ 80, φ 100	20	80	105	M20 × 1.5	40	20	40



Type	Filename
Y-M10 × 1.25	YM10125
Y-M12 × 1.25	YM12125
Y-M16 × 1.5	YM16150
Y-M20 × 1.5	YM20150

● Oscillating Eye

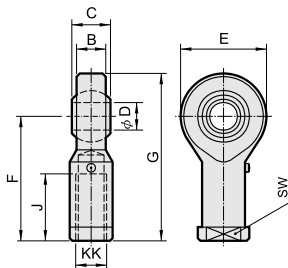

Dimensional Table

Type	Bore	B	C	D	E	F	G	J	KK	SW
G-M10 × 1.25	φ 32	10.5	14	10	28	43	57	20	M10 × 1.25	17
G-M12 × 1.25	φ 40	12	16	12	30	50	65	24	M12 × 1.25	19
G-M16 × 1.5	φ 50, φ 63	15	21	16	38	64	83	33	M16 × 1.5	22
G-M20 × 1.5	φ 80, φ 100	18	25	20	46	77	100	40	M20 × 1.5	30



Type	Filename
G-M10 × 1.25	GM10125
G-M12 × 1.25	GM12125
G-M16 × 1.5	GM16150
G-M20 × 1.5	GM20150

● Compensating Joint

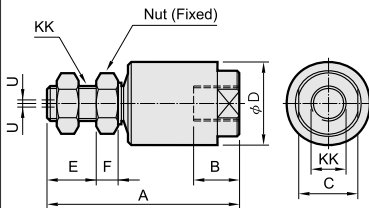

Dimensional Table

Type	Bore	A	B	C	D	E	F	KK	U
K-M10 × 1.25	φ 32	54	13	24	25.5	14.5	6	M10 × 1.25	1
K-M12 × 1.25	φ 40	70	17	29	31	19	7	M12 × 1.25	1.15
K-M16 × 1.5	φ 50, φ 63	88	21	27	38	29	8	M16 × 1.5	1.65
K-M20 × 1.5	φ 80, φ 100	105	25	32	50	27.5	16	M20 × 1.5	2.15



Type	Filename
K-M10 × 1.25	KM10125
K-M12 × 1.25	KM12125
K-M16 × 1.5	KM16150
K-M20 × 1.5	KM20150

● Mounting Nut

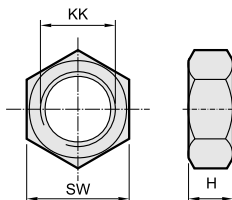

Dimensional Table

Type	Bore	H	KK	SW
N-M10 × 1.25	φ 32	6	M10 × 1.25	17
N-M12 × 1.25	φ 40	7	M12 × 1.25	19
N-M16 × 1.5	φ 50, φ 63	8	M16 × 1.5	24
N-M20 × 1.5	φ 80, φ 100	8	M20 × 1.5	27



Type	Filename
N-M10 × 1.25	NM10125
N-M12 × 1.25	NM12125
N-M16 × 1.5	NM16150
N-M20 × 1.5	NM20150

DA

DP

DS

DQ

DB

DN

BN

ST

NT

DU

DJ

TA

GP

GS

GM

GT

RT

CT

CH